

Installation / Care / Use Manual

Original Instructions

Model: EHFSA8S2ZJO, EHFSA8L2ZJO



Description

Combination Refrigerated Drinking Fountain (Cooler) delivers chilled, clean potable drinking water. Water Cooler houses the refrigeration and delivers a steady stream of water for direct drinking at the press of the front and side pushbars.

Ratings

- Electrical: 230Vac, 50Hz, (See nameplate for Amperage), 1 phase.
- Ambient Air Temperature: 50-100.4 °F (10-38 °C).
- Water Pressure: 20-100 psig (0.14-0.69 MPa).
- Maximum Water Temperature: 90 °F (32 °C).
- Refrigerant: HFC-R134a
- Ingress Protection: IP21
- For Indoor Commercial Use only.
- Water Inlet: 3/8" O.D. unplated copper tube.
- Waste Water Outlet: 1-1/4" O.D. tube

Definitions

DANGER – Indicates death or serious injury will result if proper precautions are not taken.

WARNING – Indicates death, serious injury or property damage can result if proper precautions are not taken.

CAUTION – Indicates some injury or property damage may result if proper precautions are not taken.

Authorized Service Personnel – Factory trained personnel or personnel having working knowledge of electrical, plumbing and machine (appliance) maintenance procedures.

Safety

DANGER

- Please read these instructions completely before starting the installation or performing any service. Failure to follow the instructions and safety precautions in this manual can result in serious injury or death.
- After installation, keep these instructions in a safe location for future reference.
- Electric supply must be identical in voltage, cycle, and phase to that specified on nameplate.
- Electrical supply must have Ground Fault Circuit Interrupter (GFCI) protection.
- A means for disconnecting electrical supply to the unit must be incorporated in the fixed wiring in accordance with wiring rules. This is to allow electrical disconnection of the unit from electrical supply after installation.

WARNING

- For use with clean, clear potable drinking water only. Do not use with water that is microbiologically unsafe or of unknown quality without adequate disinfection before the system.
- Installation and connection to water and electrical mains must be in compliance with local and national laws.
- All Installation and Service work must be performed by an authorized service personnel.

CAUTION

- This appliance can be used by children aged from 8 years and above and persons with reduced physical, sensory, or mental capabilities or lack of experience and knowledge if they have been given supervision or instructions concerning use of the appliance in a safe way and understand the hazards involved. Children shall not play with the appliance. Cleaning and user maintenance shall not be made by children without supervision.
- To prevent a metallic taste or increased metal content in the water due to an electrolysis process caused by electrical feedback from the grounding of electrical equipment to water supply and water waste mains, connect to these mains using non-conductive materials. The provided non-metallic In-line Strainer meets this requirement.

Installation

For correct and safe installation, please read these instructions completely.

DANGER

- All Installation work must be performed by an authorized service personnel.
- Disconnect electrical supply serving the Installation area to reduce risk of electrocution.
- Unit not suitable for installations where water jets could be used.

WARNING

- Shut off water supply serving the Installation area to reduce risk of water damage.
- Ensure proper ventilation by maintaining clearance from cabinet louvers to wall on each side of Cooler as specified in Rough-In.
- Never wire compressor directly to electrical supply.
- Do not solder tubes inserted into the In-line Strainer as damage to the o-rings may result.
- Thoroughly flush all water lines and fittings of all foreign matter before connecting to Cooler.
- Warranty is void if the plumbing kit or glass filler is not specified for use by the Manufacturer for this particular model.
- Warranty is void if Installation is not made in accordance with current Manufacturing instructions.

CAUTION

- Hose-sets are not to be used for connecting to water mains.
- If inlet pressure is above 100 psig (0.69 MPa), a pressure regulator must be installed in water supply line. Any damage caused by reason of connecting this product to water supply line pressure outside its rated pressure, is not covered by warranty.
- This cooler is manufactured in such a manner that it does not in any way cause taste, odor, color, or sediment problems. If a taste, odor or sediment problem is prevalent, try installing our water filter on the supply line.
- Tools/Items required but not provided.
 - o Water Shut-off Valve with 3/8" (9.5mm) compression outlet.
 - o Waste Trap (non-metallic)
 - o Safety Glasses
 - o Protective Gloves
 - o #20 Torx Driver or Flathead Screwdriver
 - o Fasteners for wall type

Installation: Mounting Plate

1. Select installation location. Installation location must be a clear vertical surface for the cooler to be mounted on and have adequate clear area to ventilation louvers for proper air flow. (102 mm / 4 inches minimum to adjacent walls).
2. Installation area must also include water supply, electrical supply and suitable drain. Water, drain and electrical supply systems must comply with local code requirements.
3. Remove Mounting Plate from Cooler (if fastened to Cooler).
4. Mount the Mounting Plate as shown in Rough-In drawing (Fig. 1)
 - NOTE: Mounting Plate MUST be supported securely. Add fixture support carrier if wall will not provide adequate support.
5. Anchor Mounting Plate securely to wall using six (6) mounting holes.

Installation: Cooler Mounting

1. Remove Cooler from Box.
2. Hang Cooler on the Mounting Plate. Be certain the Mounting Plate is engaged properly on the cross brace at Cooler back as shown in Rough-In (Fig. 1).
3. Loosen the two (2) screws holding the front panel at the bottom of cooler base. Remove the front panel and set aside.

Installation: Water Line connection

1. Ensure Mains Water Supply has Water Shut-off Valve with 3/8" (9.5mm) compression outlet.
2. Connect loose end of supplied 3/8" (9.5mm) unplated copper tube to Water Shut-off Valve. Other end of tube should be connected to inlet of In-line Strainer. If not connected, simply insert into inlet until positive stop – approximately 3/4" (19mm).
 - NOTE: If 3/8" (9.5mm) copper tube must be cut for proper fit, remove all burrs from the outside of tube and re-flush before use.
3. Install waste trap. Remove the slip nut and gasket from the waste trap and install them on the Cooler waste line making sure that the end of the waste line fits into the waste trap. Assemble the slip nut and gasket to the trap and tighten securely.
4. It is recommended that the waste trap be insulated to avoid excessive condensation due to chilled water running through the waste trap.
5. Turn on building water supply and open Water Shut-off Valve. Check all connections for leaks and correct any found.

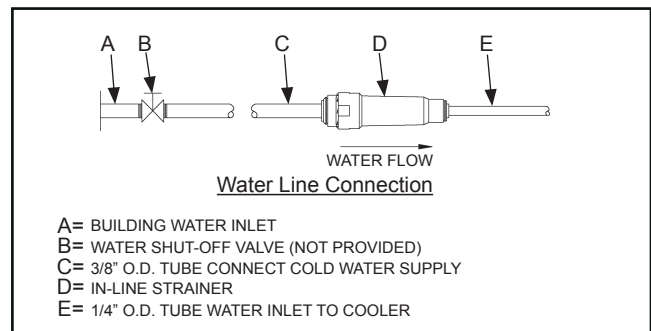

Installation: Electrical connection

1. Rotate fan to insure proper clearance and free fan action.
2. Connect modular (C-13) end of International Power Cord Set (sold separately) into Power Inlet on unit and ensure plug-end reaches electrical outlet. Do not plug into electrical outlet!

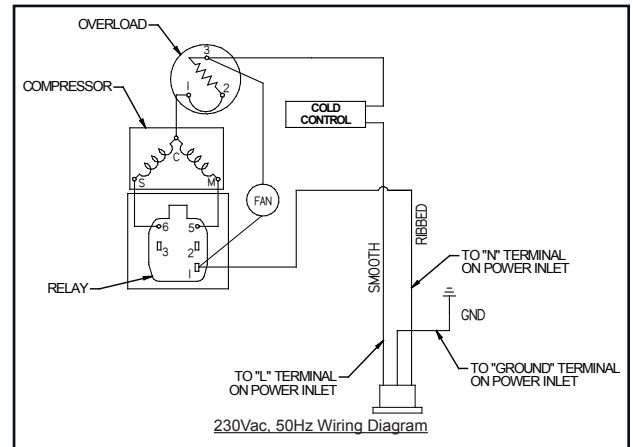

Rough-In: EHFSA8S2ZJO

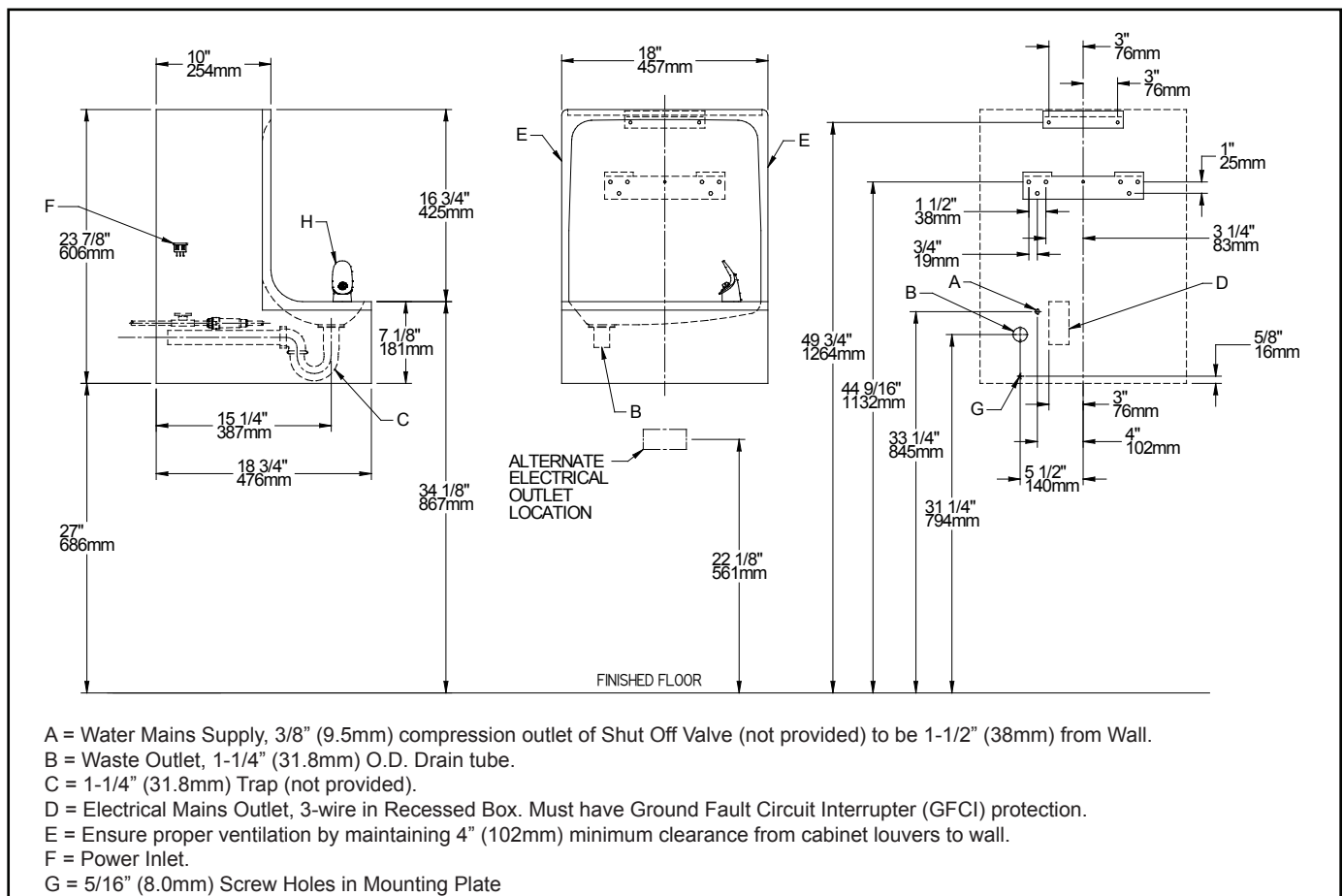

Figure 1

Operation: Start-Up

1. Turn on the building water supply and check all connections for leaks.
2. Purge air from all water lines by depressing button or front push bar of cooler/fountain.
3. Recheck all water and drain connections with water flowing through system.
4. Rotate fan to insure proper clearance and free fan action.
5. Connect plug-end of International Power Cord Set (sold separately) into electrical outlet.
6. After verifying that the water cooler is properly connected and operational, replace and reattach the cooler front panel by retightening screws

Service

For proper and safe servicing, please read these instructions completely.

DANGER

- All Service and Maintenance must be performed by an authorized service personnel.
- Disconnect electrical supply to the unit before any service work to reduce risk of electrocution.
- Shut off water supply serving the unit before any service work to reduce risk of water damage.

CAUTION

- Tools/Items required but not provided, for Servicing:
 - o Safety Glasses
 - o Protective gloves
 - o Hex drives.

Service: Adjustments

1. Temperature Control: Factory set for 50°F ± 5° (10°C ± 5°) water under normal conditions. To adjust water temperature, turn screw on Item No. 32 clockwise for colder, counter clockwise for warmer.
2. Water Stream Height: Stream height is factory set at 35 psig (0.24MPa). If supply pressure varies greatly from this, adjust screw accessible by removing front push panel. Clockwise adjustment will raise stream and counter-clockwise adjustment will lower stream. For best adjustment, stream should hit basin approximately 6-1/2" (165mm) from bubbler.
3. Water coming out of Bubbler continuously: When this occurs at the end of the compressor cycle, turn the cold control warmer (counter-clockwise) ¼ turn.

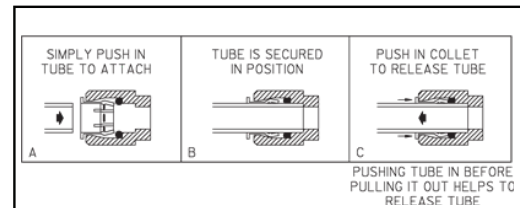

Service: Inspection/Cleaning

- Inspect Cooler twice each year for proper operation and performance.
 - Inspection of the unit will require disconnecting electrical supply, removal of panels, etc. and reassembly and return to service practices.
1. Cleaning: Warm, soapy water or mild household cleaning products can be used to clean the exterior panels. Extra caution should be used to clean the mirror finished stainless steel panels. They can be easily scratched and should only be cleaned with mild soap and water or Windex glass cleaner and a clean, soft cloth. Use of harsh chemicals or petroleum based or abrasive cleaners will void the warranty.
 2. Bubbler: Mineral deposits on the orifice can cause water flow to spurt or not regulate. Mineral deposits may be removed from the orifice with a small round file not over 1/8" (3 mm) diameter or small diameter wire.
 - CAUTION: DO NOT file or cut orifice material. Care must be taken not to damage the orifice(s)
 3. Condenser Fan Motor: Confirm condenser fan turns freely. If the condenser fan does not spin freely, have an authorized service personnel replace.
 4. Ventilation: Cabinet louvers and condenser fins should be periodically cleaned with a brush, air hose or vacuum cleaner. Cleaning should be done twice each year or more frequently if needed due to environment. Excess dirt or poor ventilation can cause no cold water and compressor cycling on the compressor overload protector.
 5. Water Flow: Confirm proper water flow. If water flow is slow, inspect filter or inline strainer for restriction. Replace filter cartridge if required. Disassemble inline strainer and clean if required.
 6. Lubrication: Motors are lifetime lubricated.
 7. Actuation of Quick Connect Water Fittings: Cooler is provided with lead-free connectors which utilize o-ring water seal. To remove tubing from the fitting, relieve water pressure, push in on the gray collar before pulling on the tubing. To insert tubing, push tube straight into fitting until it reaches a positive stop, approximately 3/4" (19mm).

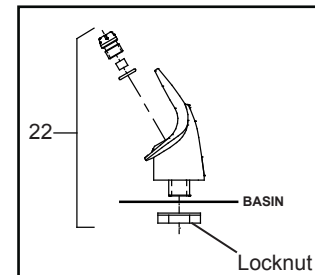

Service: Inspection/Replacement

- Inspect Cooler twice each year for proper operation and performance.
 - Inspection of the unit will require disconnecting electrical supply, removal of panels, etc. and reassembly and return to service practices.
1. Front Panel: To access the refrigeration system and plumbing connections, remove two(2) screws from bottom of cooler to remove front panel.
 2. Bubbler: To remove the bubbler, first disconnect the electrical supply. The underside of the bubbler can be reached through the front opening on the underside of the basin. Remove the front panel by removing the retaining screws. To remove the bubbler, loosen locknut from the underside of the bubbler and remove the tubing from the quick connect fitting (see above). When installing replacement bubbler and pedestal, tighten nut only to hold parts snug in position. Do Not Overtighten. After servicing, replace the front panel and two (2) screws.
 3. Cleaning Strainer: Restricted water flow may be caused by clogged screen. Remove plug and screen. Clean screen and replace. Lubricate O-Ring with food grade pharmaceutical mineral oil. Do not overtighten plug or fittings.

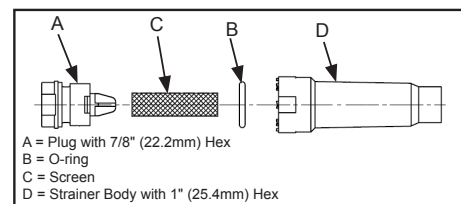

Replacement Parts: 230V-50Hz Parts List

Item No.	Part No.	Description
1	26588C	Panel - Bottom Dispenser
2	55996C	Strainer
3	111411743620	Nut - 1/4, Self-Threading
4	98789C	Kit - Pushbar Brackets/Screws
5	See Color Table	Panel - Right Side
6	See Color Table	Panel - Left Side
7	See Color Table	Panel - Front Push
8	98791C	Kit - Side Pushbar (Gray)
9	0000000242	Kit - Front Pushbar (Brown)
10	98789C	Kit - Pushbar Bracket/Screws
11	98537C	Kit - Pushbar/Pivot Blocks/Bumpers
12	40045C	Hex Nut
13	23003C	Bracket - Regulator Mounting
14	98531C	Kit - Regulator with Green Spring
15	70935C	Screw - Shoulder x 1/2" Lg.
16	75502C	Screw - #10-16 X .50 THSM
17	See Color Table	Wrapper
18	36208C	Power Inlet
19	27095C	Fan Bracket
20	98775C	Kit - Fan Motor Assy/Blade/Motor/Shroud/Screws/Nut
21	70142C	Clip (Front and Rear Panels)
22	56073C	Bubbler Assembly
23	98776C	Kit - Condenser/Drier
24	66703C	Drier
25	0000000252	Kit - Compr Mtg Hdwe/Grommets/Clips/Washers
*26	36322C	Compressor Serv. Pak
27	0000000238	Kit - Compr Electrical /Relay/Overload/Cover
28	98778C	Kit - Heat Exchanger/Drier
29	98790C	Kit - Drain /Tailpipe/Strainer Assy/Gasket
30	21222C	Basin - Stainless Steel
31	75536C	Screw - #10 X .63 THSM
32	98773C	Kit - Cold Control/Screws
33	0000000886	Kit - Evaporator Assembly
34	70682C	Tee - 1/4" (Not Shown)
35	27093C	Angle - Bracket Corner
36	27094C	Bracket - Front Support
37	28797C	Bracket - Basin Mounting
38	27097C	Frame - Back/Bottom
39	20430C	Hanger Bracket
40*	20774C	Hanger Bracket
41	56092C	Tubing-Poly (Cut to Length)
42	100322740560	Gasket (GF)
43	15009C	Nipple Assy. (GF)
44	31525028	O-Ring
45	40493C	Glass Filler

*Includes Relay & Overload. If under Warranty, replace with same Compressor used in original assembly.

NOTE: All correspondence pertaining to any of the above water cooler or orders for repair parts MUST include Model number and Serial number of cooler, name and number of replacement part.

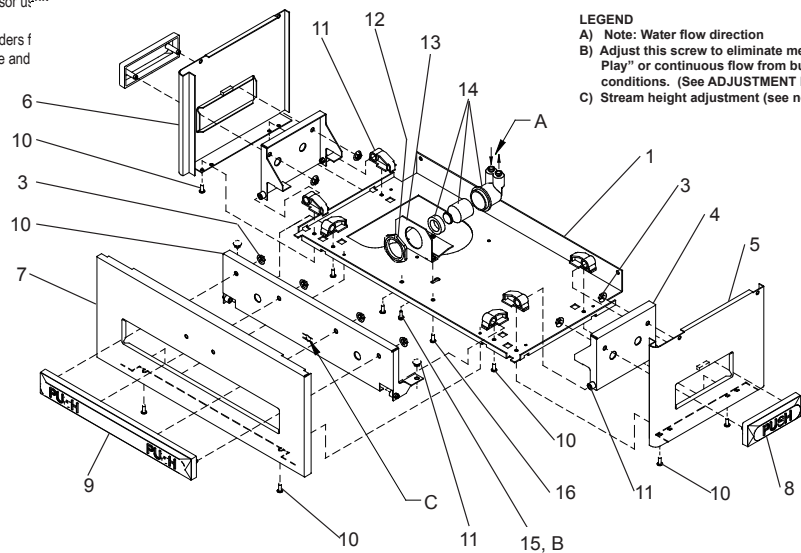
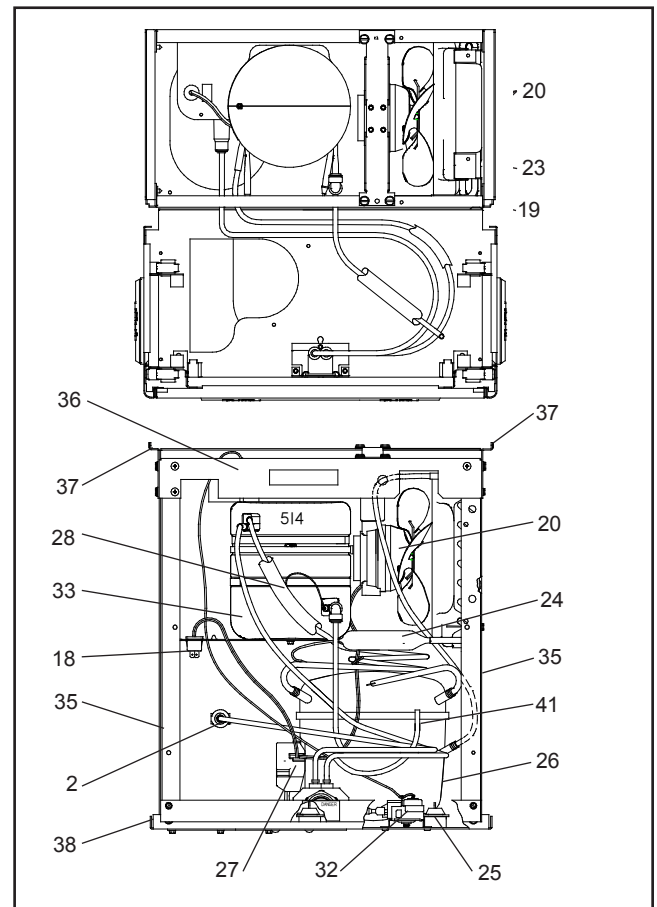

Replacement Parts: Color Table

COLOR TABLE PANEL COLOR	Item No. 5 Part No. (w/o holes)	Item No. 5 Part No. (w/ holes)	Item No. 6 Part No. (w/o holes)	Item No. 6 Part No. (w/ holes)	Item No. 7 Part No.	Item No. 17 Part No.
Gray Beige	26635C	26650C	26605C	26620C	26590C	22706C
Almond	26636C	26651C	26606C	26621C	26591C	22707C
Stainless Steel	26637C	26652C	26607C	26622C	26592C	22708C
Sandalwood	26638C	26653C	26608C	26623C	26593C	22709C
Granite	26641C	26656C	26611C	26626C	26596C	22711C
Light Gray	26642C	26657C	26612C	26627C	26597C	22712C

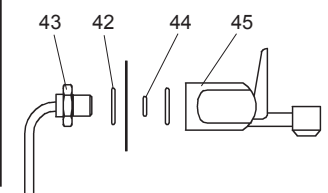

Repair Service Information Toll Free Number 1.800.260.6640
For Replacement Parts, contact your local distributor or call 1.800.834.4816

Elkay Manufacturing Co. 2222 Camden Court – Oak Brook, IL 60523 U.S.A – 630.574.8484